

# LAKE SURVEY MAP

HALSEY LAKE  
FLORENCE COUNTY  
SEC. 16-20-21 T. 39 N. R. 15 E.W.

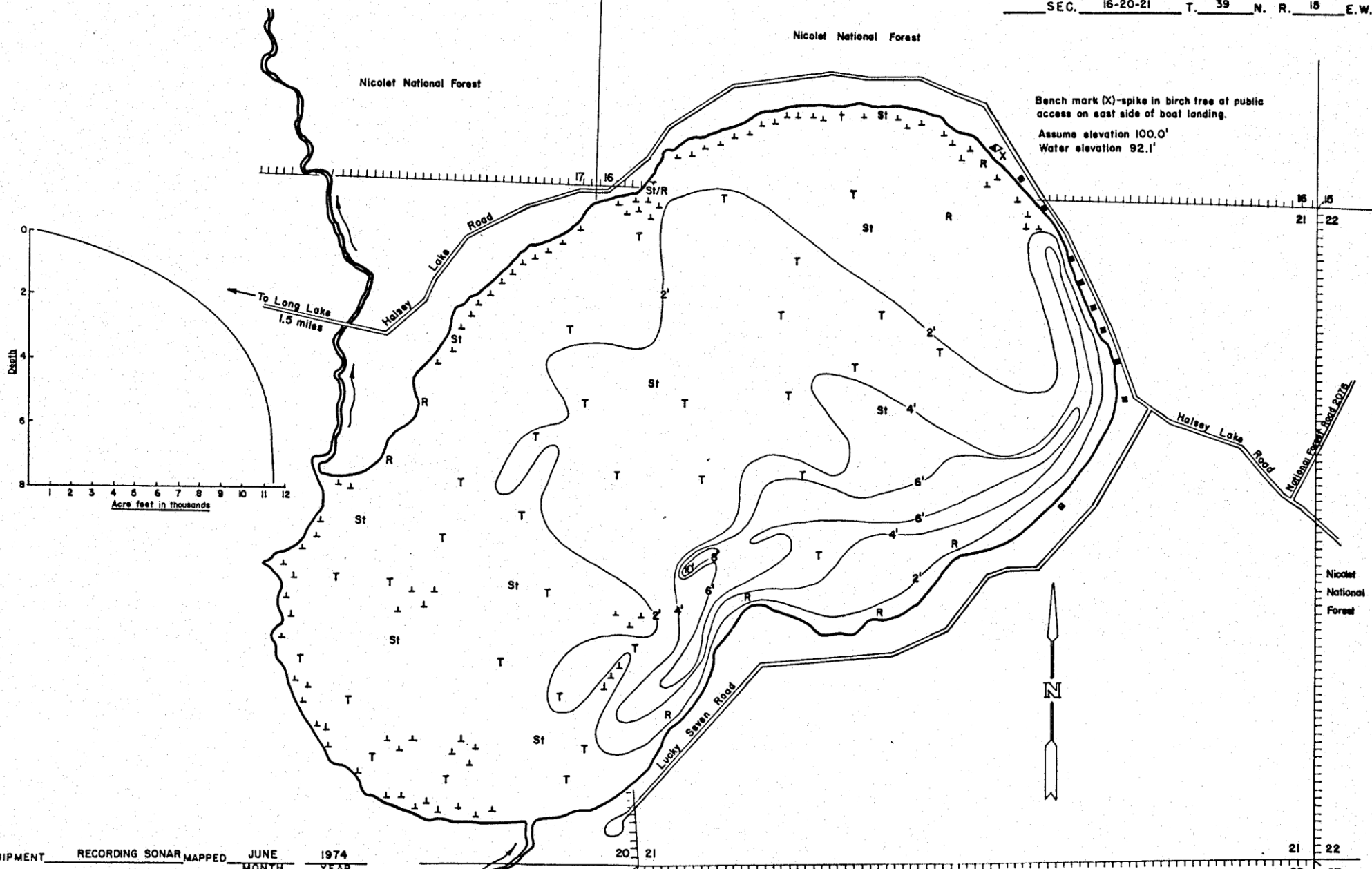

Bench mark (X)-spike in birch tree at public access on east side of boat landing.  
Assume elevation 100.0'  
Water elevation 92.1'

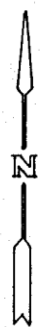
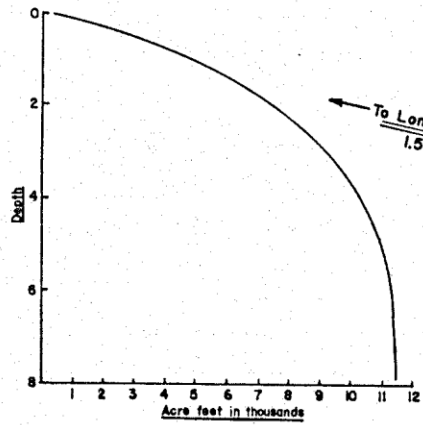

EQUIPMENT	RECORDING	SONAR MAPPED	JUNE 1974	MONTH LAKE BOTTOM	YEAR SYMBOLS
TOPOGRAPHIC SYMBOLS					
Brush		Steep slope	P. Peat	B. Boulders	
Partially wooded		Indefinite shoreline	Mk. Muck	S. Slumps & Snags	
Wooded		Marsh	C. Clay	R. Rock danger to navigation	
Cleared		Spring	M. Marl	T. Submergent vegetation	
Pastured		Intermittent stream	Sd. Sand	E. Emergent vegetation	
Agricultural		Permanent inlet	St. Silt	F. Floating vegetation	
Bench Mark	M.	Permanent outlet	G. Gravel	Br. Brush shelters	
Dwelling	D.	Dam	R. Rubble		
Resort	R.	D.N.R. State owned land	Bc. Bedrock		

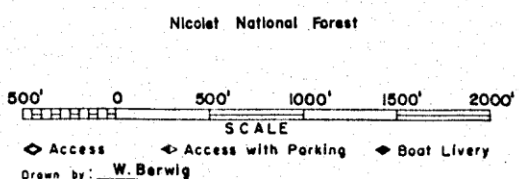

SPECIES OF FISH	Abundance		
	Abundant	Common	Present
Muskie			
N. Pike	X		
Walleye		X	
L. M. Bass			X
S. M. Bass			X
Panfish	X		

WATER AREA 516.5 ACRES  
 UNDER 2 FT. 65 %  
 OVER 20 FT. %  
 MAX. DEPTH 10 FEET.  
 TOTAL ALK. 69 P.P.M.  
 VOLUME 1147.66 ACRE FT.  
 MAIN SHORELINE 4.09

